

Whitewater

Plat of Survey

of

Lot 5 of Block 1 of Oakwood Heights Subdivision,

located in the Southeast 1/4 of Section 3, Town 3 North, Range 15 East,
Town of Richmond, Walworth County, Wisconsin.

Surveyed for: **Keefe Real Estate, Inc.**

751 Geneva Parkway * P.O. Box 460
Lake Geneva, Wisconsin. 53147

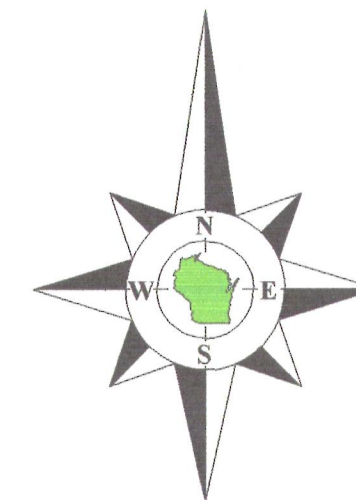

Bearings referenced to the plat of
Oakwood Heights Subdivision.

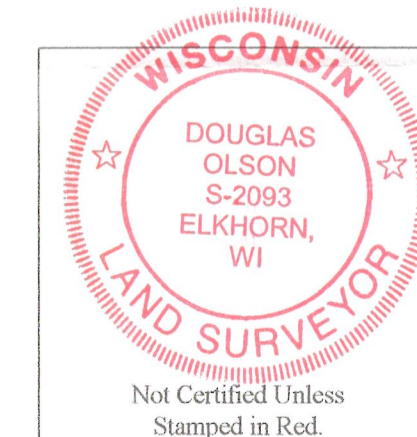

Notes:

- 1) This survey plat is not certified unless signed and sealed in red ink.
- 2) This survey is subject to Wisconsin lien laws. This Plat of Survey is the notice of intent to file lien. Lien waiver required.

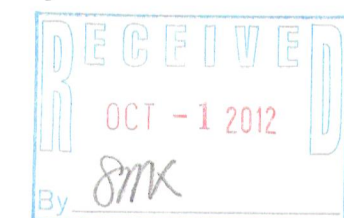

Copyright 2012 by Jensen & Olson Land Surveying, LLC.

All rights reserved. No part of this survey plat may be reproduced or transmitted in any form by any means - graphic, electronic, or mechanical, including photocopying, tracing, or information storage and retrieval systems - without permission in writing from Douglas G. Olson, Jensen & Olson Land Surveying, LLC.

I hereby certify that I have surveyed the above described property and the map hereon is correct to the best of my professional knowledge and belief and shows the size and location of the property, its exterior boundaries, the location and dimensions of all visible structures thereon, boundary fences, apparent easements and roadways and visible encroachments, if any.

This survey is made for the exclusive use of the present owners of the property, and also those who purchase, mortgage or guarantee title thereto, within one year from the date hereof.

Douglas G. Olson
Wisconsin Registered Land Surveyor - 2093

Survey Date: June 21, 2012.
Revisions:

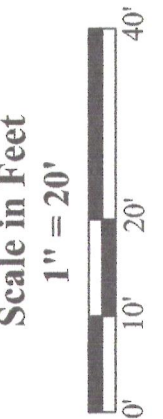

Jensen & Olson Land Surveying, LLC
45 South Wisconsin Street * P.O. Box 322 * Elkhorn, Wisconsin. 53121
Telephone: (262) 723-3434 * Facsimile: (262) 723-8044
Email: jensen.olson@elknet.net

Legend
Found Iron Pipe 1" dia.
Set Iron Pipe 1" dia.
Set Chiseled Cross on Rock
Recorded Information
Utility Pedestal
Asphalt Surface
Concrete Surface
Gravel

Sheet 1 of 1 Sheets
Job Reference Number
2012.065

2012.065

COWB-5

315-1180